

# selkirk flood protection scheme

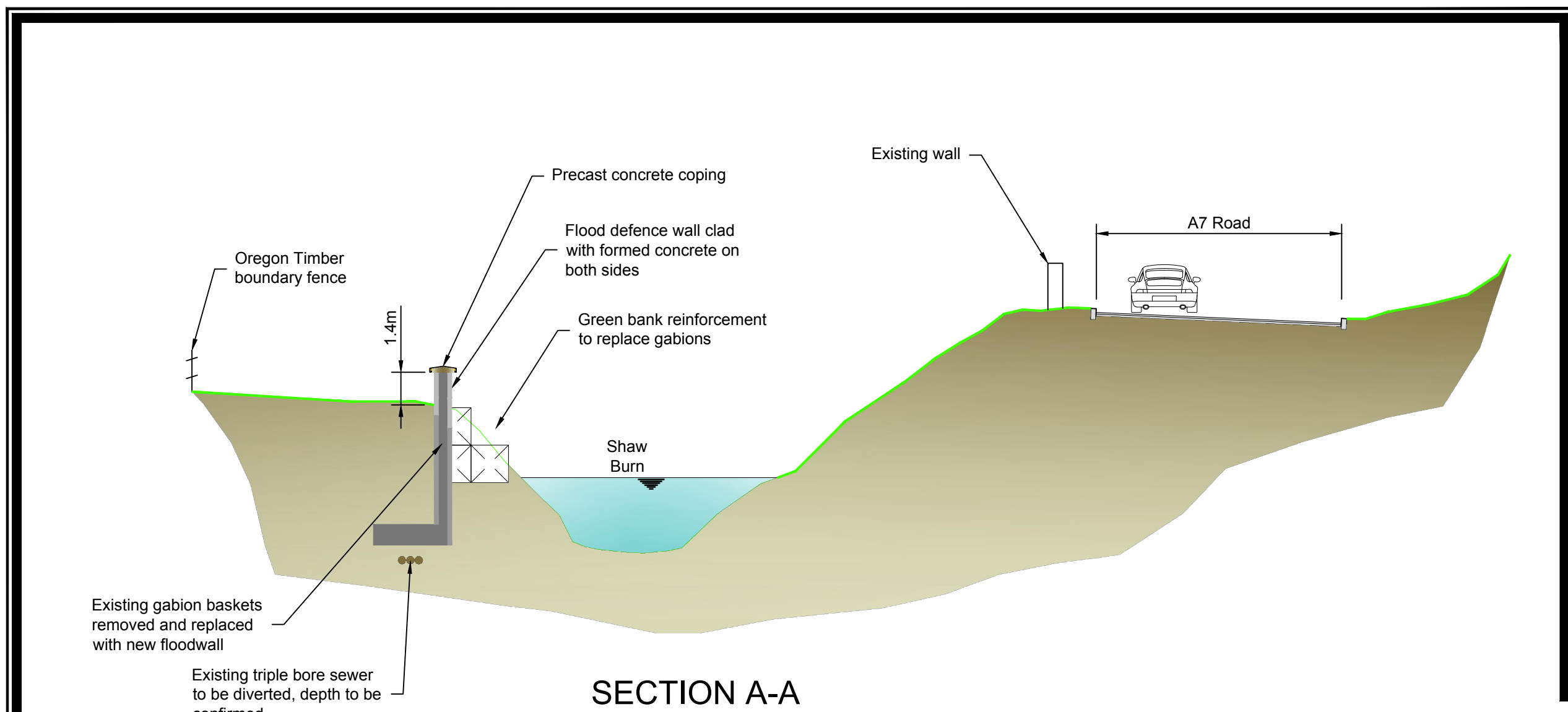

## Shaw Burn Flood Risk Reduction Measures

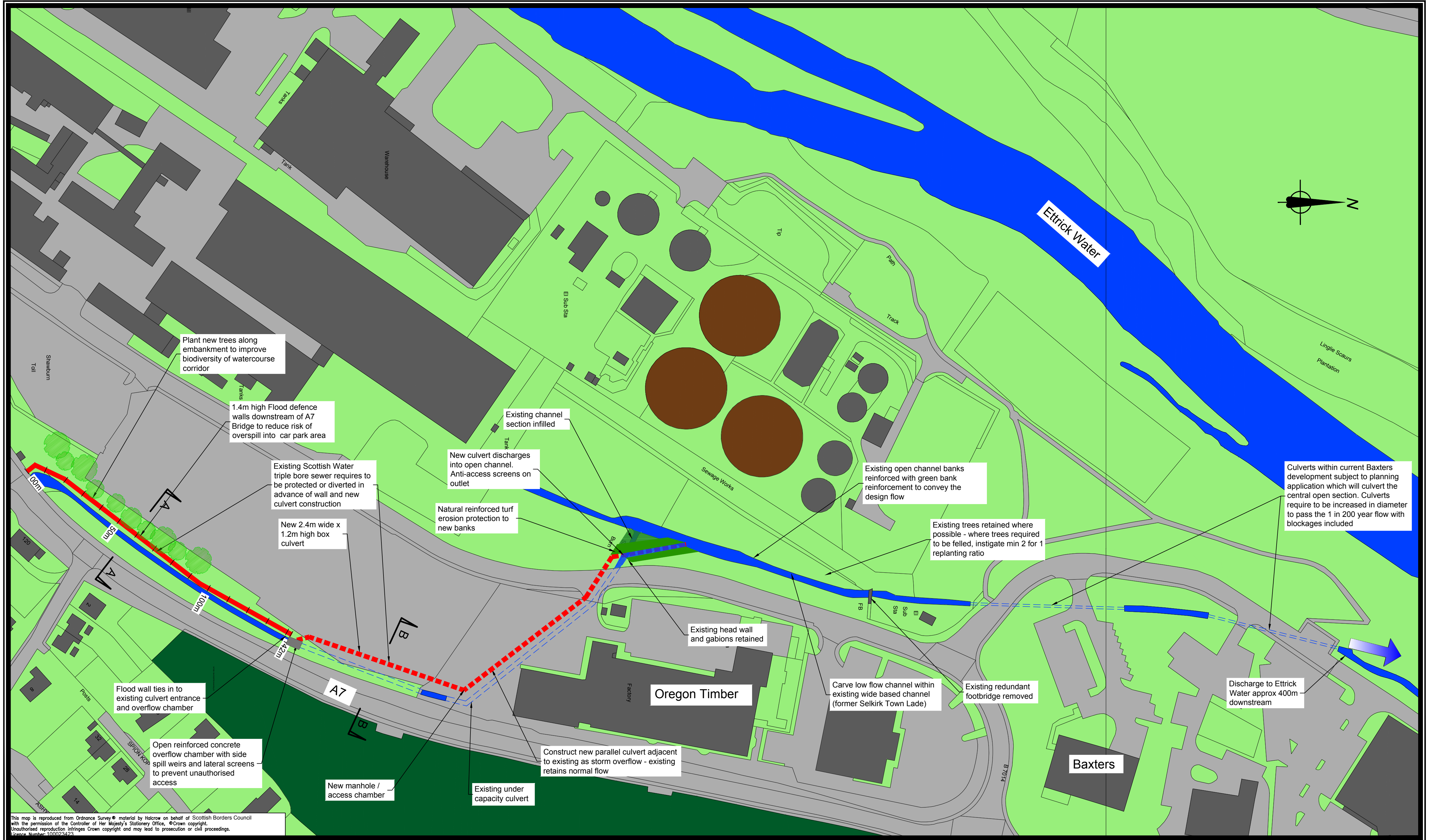

- KEY FACTS**
- Provide protection against the 1 in 200 plus climate change flood event
  - The 1 in 200 + climate change flood event affects around 38 business properties at the eastern end of the Riverside Business Park
  - Provide a combination of improved flood defence walls up to 1.5m above existing ground level and improved conveyance at under capacity culverts
  - Requires 150m of flood defence wall and a minimum of 175m of replacement culvert
  - Utilise formed concrete brickwork finish for exposed flood defence wall surfaces
  - Require to divert existing triple bore Scottish Water sewer.
  - Some culvert improvement works subject to planning approval on proposed development of the Baxters / Co-Op NGT site

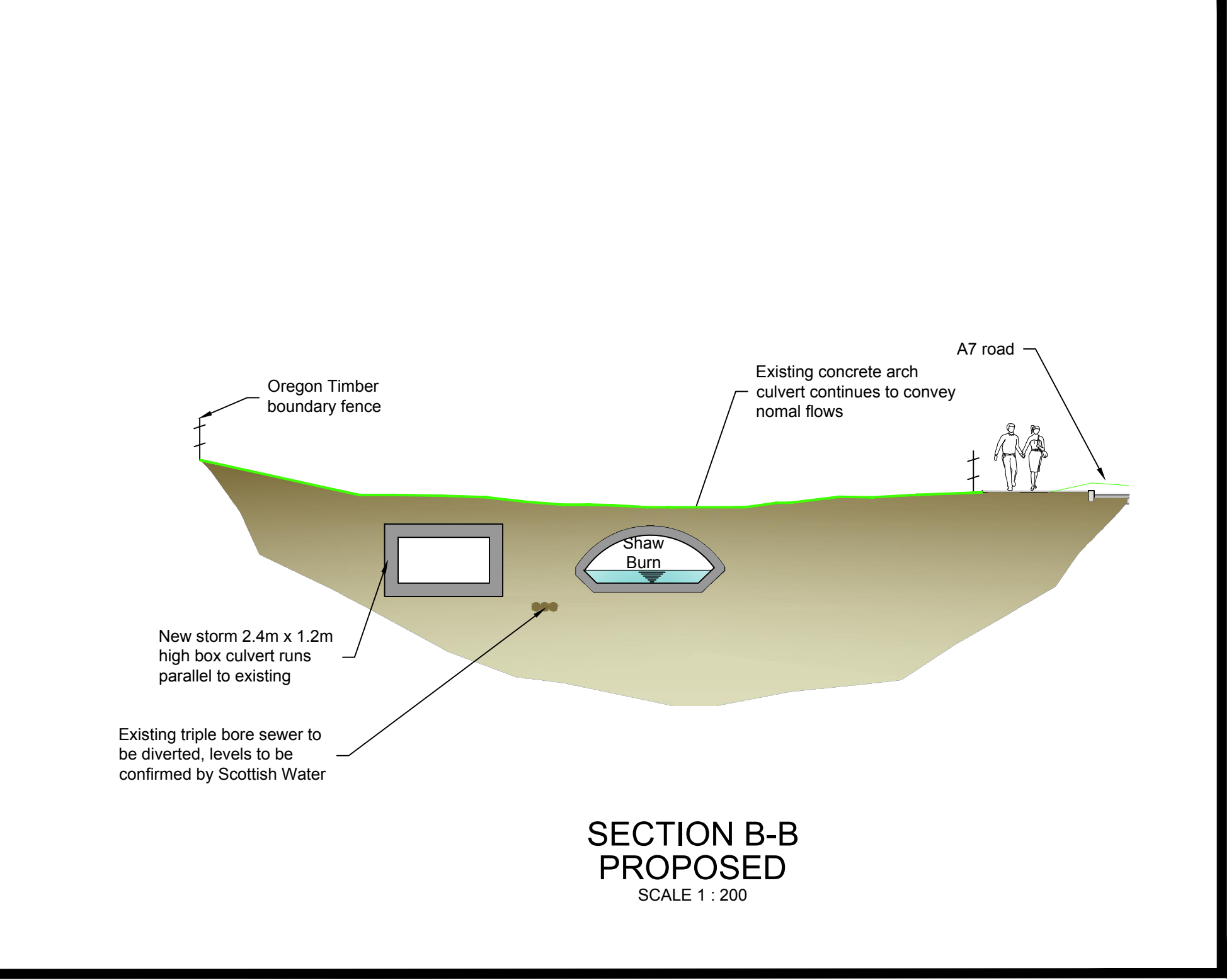
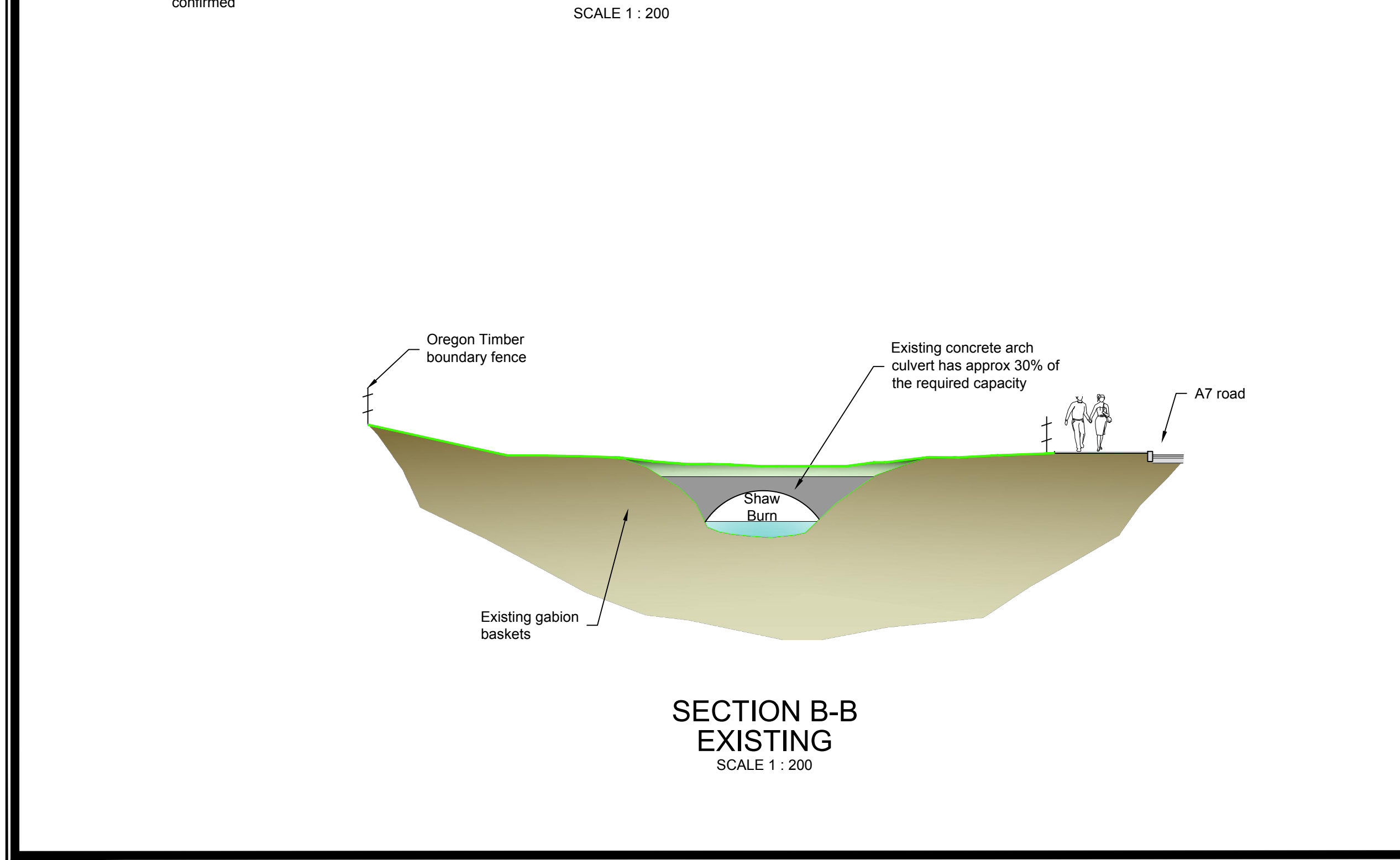

Typical Sections